



# PRESSURE VESSELS – PV & HPV

## DESCRIPTION

Pressure vessels are tanks, designed to store compressed air. On request, pressure vessels can also be designed for any other technical gas. Size of pressure vessel depends on compressor capacity and on consumption of compressed air.

### The supply of pressure vessel includes:

- Anticorrosion protection (external painting or hot dip galvanizing)
- CE certificate (PV 200-900); PED 2014/68/EU CE (PV 1000-10000)
- Supporting legs
- Connections for optional equipment
- INSPECTION OPENING:
  - Optional: HPV/PV 1000 - 10000
  - Mandatory: PV Galvanized 4000 & larger

### Optional equipment for pressure vessel:

- Pressure release safety valve
- Pressure gauge with release valve and quick coupling
- Inlet/Outlet ball valves
- Automatic condensate drain
- Condensate drain pipe
- Plugs for spare connections



## TECHNICAL SPECIFICATIONS:

MODEL	Max. working pressure	Min./Max. working temperature	Fluid group 2	Fluid group 1
<b>PV (vertical / horizontal)</b>	11 bar(g)	-10°C / +120°C	Standard	On request
<b>HPV (vertical)</b>	16 / 21 / 32 / 42 / 48 bar(g)	-10°C / +120°C	Standard	On request

Two different types of pressure vessels – vertical (picture 1) and horizontal (picture 2).



Picture 1: Vertical pressure vessel

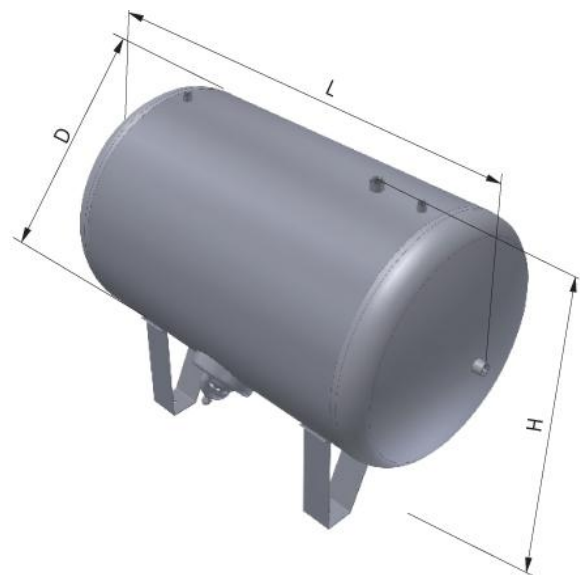

Picture 2: Horizontal pressure vessel



**PRESSURE VESSELS – PV**

**TECHNICAL DATA**

Model	Volume	Max. pressure	Connections number and dimensions									Dimensions			Mass
			3/8	1/2	3/4	1	1 1/4	1 1/2	2	3	4	H	D	L	
	l	bar	inch									mm			kg
<b>PRESSURE VESSELS - VERTICAL - PAINTED</b>															
PV 50 V 11 P	50	11	1	3	-	-	-	-	-	-	-	926	300	-	19
PV 100 V 11 P	100	11	1	1	4	-	-	-	-	-	-	1153	370	-	28
PV 150 V 11 P	150	11	1	1	-	1	-	-	-	-	-	1.364	400	-	43
PV 200 V 11 P	200	11	1	-	3	-	-	-	2	-	-	1.530	430	-	50
PV 270 V 11 P	270	11	1	-	3	-	-	-	2	-	-	1.685	500	-	60
PV 500 V 11 P	500	11	1	-	1	-	2	2	-	-	-	2.077	600	-	130
PV 725 V 11 P	725	11	1	-	1	-	2	2	-	-	-	1.863	790	-	167
PV 900 V 11 P	900	11	1	-	1	-	2	-	2	-	-	2.213	790	-	186
PV 1000 V 11 P	1.000	11	1	-	1	-	2	-	2	-	-	2.345	790	-	204
PV 1500 V 11 P	1.500	11	1	-	1	-	2	-	2	-	-	2.305	1.000	-	278
PV 2000 V 11 P	2.000	11	1	-	1	-	2	-	2	-	-	2.805	1.000	-	352
PV 3000 V 11 P	3.000	11	1	-	1	-	2	-	-	2	-	2.965	1.300	-	537
PV 4000 V 11 P	4.000	11	1	-	1	-	2	-	-	2	-	3.070	1.450	-	802
PV 5000 V 11 P	5.000	11	1	-	1	-	2	-	-	2	-	3.570	1.450	-	932
PV 6000 V 11 P	6.000	11	1	-	1	-	2	-	-	2	-	4.070	1.450	-	1.057
PV 8000 V 11 P	8.000	11	1	-	-	-	2	-	-	-	2	4.135	1.650	-	1.352
PV 10000 V 11 P	10.000	11	1	-	-	-	2	-	-	-	2	5.135	1.650	-	1.694
<b>PRESSURE VESSELS - VERTICAL - GALVANIZED</b>															
PV 50 V 11 G	50	11	1	2	-	1	-	-	-	-	-	926	300	-	19
PV 100 V 11 G	100	11	1	-	4	-	-	-	1	-	-	1.153	370	-	28
PV 150 V 11 G	150	11	1	-	-	4	-	-	1	-	-	1.364	400	-	43
PV 200 V 11 G	200	11	1	-	3	-	-	-	2	-	-	1.530	430	-	50
PV 270 V 11 G	270	11	1	-	3	-	-	-	2	-	-	1.685	500	-	60
PV 500 V 11 G	500	11	1	-	1	-	2	2	-	-	-	2.077	600	-	130
PV 725 V 11 G	725	11	1	-	1	-	2	2	-	-	-	1.863	790	-	167
PV 900 V 11 G	900	11	1	-	1	-	2	-	2	-	-	2.213	790	-	186
PV 1000 V 11 G	1.000	11	1	-	1	-	2	-	2	-	-	2.345	790	-	204
PV 1500 V 11 G	1.500	11	1	-	1	-	2	-	2	-	-	2.305	1.000	-	278
PV 2000 V 11 G	2.000	11	1	-	1	-	2	-	2	-	-	2.805	1.000	-	352
PV 3000 V 11 G	3.000	11	1	-	1	-	2	-	-	2	-	2.965	1.300	-	537
PV 4000 V 11 G	4.000	11	1	-	1	-	2	-	-	2	-	3.070	1.450	-	802
PV 5000 V 11 G	5.000	11	1	-	1	-	2	-	-	2	-	3.570	1.450	-	932
PV 6000 V 11 G	6.000	11	1	-	1	-	2	-	-	2	-	4.070	1.450	-	1.057
PV 8000 V 11 G	8.000	11	1	-	-	-	2	-	-	-	2	4.135	1.650	-	1.352
PV 10000 V 11 G	10.000	11	1	-	-	-	2	-	-	-	2	5.135	1.650	-	1.694



**PRESSURE VESSELS – PV**

**TECHNICAL DATA**

Model	Volume	Max. pressure	Connections number and dimensions									Dimensions			Mass
			3/8	1/2	3/4	1	1 1/4	1 1/2	2	3	4	H	D	L	
	l	bar	inch									mm			kg
<b>PRESSURE VESSELS - HORIZONTAL - PAINTED</b>															
PV 50 H 11 P	50	11	1	1	-	-	-	-	-	-	-	352	300	774	19
PV 100 H 11 P	100	11	2	2	1	-	-	-	-	-	-	447	370	1.010	28
PV 150 H 11 P	150	11	2	2	1	-	-	-	-	-	-	470	400	1.224	43
PV 500 H 11 P	500	11	1	2	-	1	-	-	-	-	-	670	600	1.860	140
PV 900 H 11 P	900	11	1	-	-	-	-	-	4	-	-	905	790	1.970	195
PV 1000 H 11 P	1.000	11	2	-	2	1	-	-	-	-	-	905	790	2.180	210
PV 1500 H 11 P	1.500	11	1	-	1	-	-	-	4	-	-	1.160	1.000	2.160	278
PV 2000 H 11 P	2.000	11	1	-	1	-	-	-	4	-	-	1.160	1.000	2.660	352
PV 3000 H 11 P	3.000	11	1	-	1	-	-	-	-	4	-	1.340	1.200	2.815	537
PV 4000 H 11 P	4.000	11	1	-	1	-	-	-	-	4	-	1.620	1.450	1.920	802
PV 5000 H 11 P	5.000	11	1	-	1	-	-	-	-	4	-	1.620	1.450	3.420	932
PV 6000 H 11 P	6.000	11	1	-	1	-	-	-	-	4	-	1.620	1.450	3.920	1.057
PV 8000 H 11 P	8.000	11	1	-	1	-	-	-	-	-	4	1.790	1.650	4.025	1.352
PV 10000 H 11 P	10.000	11	1	-	1	-	-	-	-	-	4	1.790	1.650	5.025	1.694
<b>PRESSURE VESSELS - HORIZONTAL - GALVANIZED</b>															
PV 50 H 11 G	50	11	1	-	-	1	-	-	-	-	-	352	300	774	19
PV 100 H 11 G	100	11	2	1	1	-	-	-	1	-	-	447	370	1.010	28
PV 150 H 11 G	150	11	2	1	1	-	-	-	1	-	-	470	400	1.224	43
PV 500 H 11 G	500	11	1	2	-	1	-	-	-	-	-	670	600	1.860	140
PV 900 H 11 G	900	11	1	-	-	-	-	-	4	-	-	905	790	1.970	195
PV 1000 H 11 G	1.000	11	2	-	2	1	-	-	-	-	-	905	790	2.180	210
PV 1500 H 11 G	1.500	11	1	-	1	-	-	-	4	-	-	1.160	1.000	2.160	278
PV 2000 H 11 G	2.000	11	1	-	1	-	-	-	4	-	-	1.160	1.000	2.660	352
PV 3000 H 11 G	3.000	11	1	-	1	-	-	-	-	4	-	1.340	1.200	2.815	537
PV 4000 H 11 G	4.000	11	1	-	1	-	-	-	-	4	-	1.620	1.450	1.920	802
PV 5000 H 11 G	5.000	11	1	-	1	-	-	-	-	4	-	1.620	1.450	3.420	932
PV 6000 H 11 G	6.000	11	1	-	1	-	-	-	-	4	-	1.620	1.450	3.920	1.057
PV 8000 H 11 G	8.000	11	1	-	1	-	-	-	-	-	4	1.790	1.650	4.025	1.352
PV 10000 H 11 G	10.000	11	1	-	1	-	-	-	-	-	4	1.790	1.650	5.025	1.694



## PRESSURE VESSELS - HPV

### TECHNICAL DATA

Model painted	Model galvanized	Volume l	Max. pressure bar	Connections number and dimensions						Dimensions		Mass kg
				1/4	3/8	3/4	1 1/4	2	3	H	D	
				inch						mm		
<b>16 bar - HIGH PRESSURE VESSELS - VERTICAL</b>												
HPV 500 V 16 P	HPV 500 V 16 G	500	16	-	1	1	2	2	-	2.120	600	160
HPV 1000 V 16 P	HPV 1000 V 16 G	1.000	16	-	1	1	2	2	-	2.365	790	280
HPV 1500 V 16 P	HPV 1500 V 16 G	1.500	16	-	1	1	-	4	-	2.310	1.000	405
HPV 2000 V 16 P	HPV 2000 V 16 G	2.000	16	-	1	1	-	4	-	2.810	1.000	490
HPV 3000 V 16 P	HPV 3000 V 16 G	3.000	16	-	1	1	-	2	2	2.965	1.200	620
HPV 4000 V 16 P	HPV 4000 V 16 G	4.000	16	-	1	1	-	2	2	3.110	1.430	905
HPV 5000 V 16 P	HPV 5000 V 16 G	5.000	16	-	1	1	-	2	2	3.610	1.430	1.055
<b>21 bar - HIGH PRESSURE VESSELS - VERTICAL</b>												
HPV 475 V 21 P	HPV 475 V 21 G	475	21	-	1	1	2	2	-	2.135	600	220
HPV 1000 V 21 P	HPV 1000 V 21 G	1.000	21	-	1	1	-	4	-	2.385	790	352
HPV 1500 V 21 P	HPV 1500 V 21 G	1.500	21	-	1	1	-	4	-	2.470	1.000	555
HPV 2000 V 21 P	HPV 2000 V 21 G	2.000	21	-	1	1	-	4	-	2.810	1.000	715
HPV 3000 V 21 P	HPV 3000 V 21 G	3.000	21	-	1	1	-	4	-	2.950	1.200	950
HPV 4000 V 21 P	HPV 4000 V 21 G	4.000	21	-	1	1	-	4	-	3.130	1.430	1.400
HPV 5000 V 21 P	HPV 5000 V 21 G	5.000	21	-	1	1	-	4	-	3.630	1.430	1.750
<b>32 bar - HIGH PRESSURE VESSELS - VERTICAL</b>												
HPV 500 V 32 P	HPV 475 V 32 G	500	32	-	1	1	-	4	-	2.140	600	245
HPV 1000 V 32 P	HPV 1000 V 32 G	1.000	32	-	1	1	-	4	-	2.390	790	505
HPV 1500 V 32 P	HPV 1500 V 32 G	1.500	32	-	1	1	-	4	-	2.500	1.000	710
HPV 2000 V 32 P	HPV 2000 V 32 G	2.000	32	-	1	1	-	4	-	2.850	1.000	875
HPV 3000 V 32 P	HPV 3000 V 32 G	3.000	32	-	1	1	-	4	-	2.950	1.200	1.170
HPV 4000 V 32 P	HPV 4000 V 32 G	4.000	32	-	1	1	-	4	-	3.100	1.430	1.700
HPV 5000 V 32 P	HPV 5000 V 32 G	5.000	32	-	1	1	-	4	-	3.600	1.430	1.950
<b>42 bar - HIGH PRESSURE VESSELS - VERTICAL</b>												
HPV 500 V 42 P	HPV 500 V 42 G	500	42	-	1	1	-	4	-	2.135	600	340
HPV 1000 V 42 P	HPV 1000 V 42 G	1.000	42	-	1	1	-	4	-	2.385	790	605
HPV 1500 V 42 P	HPV 1500 V 42 G	1.500	42	-	1	1	-	4	-	2.470	1.000	755
HPV 2000 V 42 P	HPV 2000 V 42 G	2.000	42	-	1	1	-	4	-	2.810	1.000	1.025
HPV 3000 V 42 P	HPV 3000 V 42 G	3.000	42	-	1	1	-	4	-	2.950	1.200	1.450
HPV 4000 V 42 P	HPV 4000 V 42 G	4.000	42	-	1	1	-	4	-	3.130	1.430	2.190
HPV 5000 V 42 P	HPV 5000 V 42 G	5.000	42	-	1	1	-	4	-	3.630	1.430	2.515
<b>48 bar - HIGH PRESSURE VESSELS - VERTICAL</b>												
HPV 1000 V 48 P	HPV 1000 V 48 G	790	48		1	1		4		2.400	790	725
HPV 2000 V 48 P	HPV 2000 V 48 G	1.000	48		1	1		4		2.810	1.000	1.195
HPV 3000 V 48 P	HPV 3000 V 48 G	1.200	48		1	1		4		2.970	1.200	1.685